

Case study

THE BLUFF, OXFORDSHIRE



The Bluff is a modern, contemporary house set in the side of a hill in the Cotswolds countryside.

The house was designed with sweeping curved walls of natural stone to fit in with its surroundings and to look like part of the landscape.

The natural stone was also used for some of the internal walls to create a unique interior design element.

- **Stone specified:** Golden Cream sawn on bed in bespoke course heights
- **Sector:** Private residential

Architect: Adrian James Architects

Contractor: W G Carter Construction

Photography credit: David Fisher, Fisher Studios

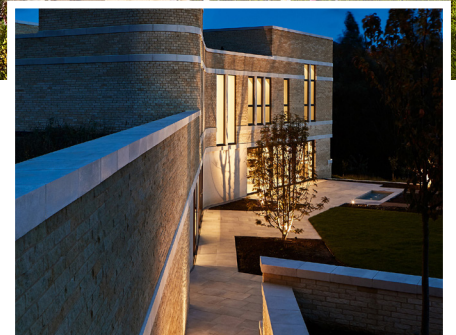

Cotswold Natural Stone Ltd

The Stoneyard, Scrubbs Lane, Shilton, Oxfordshire OX18 4AW

+44 (0)1993 867392 ■ enquiries@cns-group.co.uk ■ www.cotswoldnaturalstone.co.uk